

# EPIC DIVER

## 220-Foot DP-2 Dive Support Vessel with 1,000-Foot SAT System



Flag	Vanuatu
IMO	7423873
Built	1976/Singapore
Complete Refurbishment	January 2007

### DIMENSIONS

Registry length	191.89 feet (58.5 meters)
LOA	220 feet (67 meters)
Beam	45 feet (13.7 meters)
Draft	17 feet (297.3 meters)
Clear deck space	3,200 square feet (297.3 square meters)
Deck loading	255 long tons (571,200 pounds)
Moon Pool	9 feet (2.7 meters) midship

### CAPACITIES

Potable water	110,000 gallons
Water maker	1,680-2,000 gallons per day
Fuel	120,000 gallons

### TONNAGE

Gross registered	1,828 tons
Net registered	548 tons

### SPEED

Cruising	10 knots
----------	----------

### ACCOMMODATIONS

22 Crew  
38 Additional berths

### SHIP SAFETY

ABS Classed, in full SOLAS compliance  
Meets U.S.C.G. requirements to operate in U.S. waters

### MARINE EQUIPMENT

Main engines	(2) Wichman 7AX diesels with CP propellers
Crane	(1) Marine-rated 25-T at 39 feet, 50-T at 19 feet, with 4-T man-rated Hydrolift
Rescue equipment	(1) MOB boat

### DIVING EQUIPMENT

- (1) 6-person 1,000-foot saturation system with diver reclaim
- (1) Hyperbaric rescue chamber
- (2) Hydraulic packages
- (1) Built-in 6 x 6 inch jet pump
- (1) Built-in 400 CFM high/low compressor
- (2) Welding machines
- (2) Burning packages
- (3) Underwater video packages



*Moon Pool and 6-person SAT System*

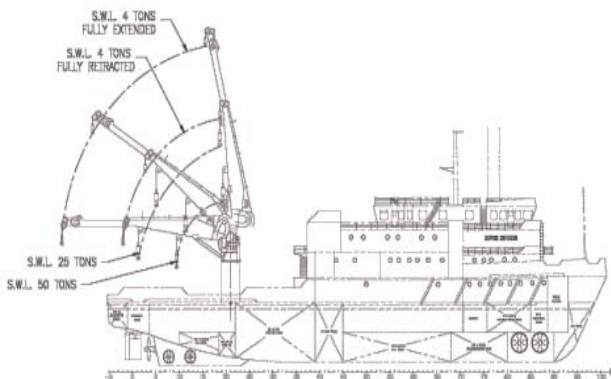

**Outboard Profile**

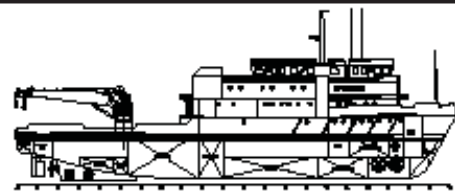

**Profile**

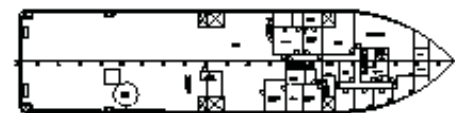

**Main Deck**

**EPIC DIVERS & MARINE**  
[www.epiccompanies.com](http://www.epiccompanies.com)

**CORPORATE OPERATIONS**  
1841 Enterprise Drive  
Harvey, LA 70058  
Ph: 504.340.5252  
Toll Free: 800.844.3742

**PROJECT MANAGEMENT**  
24955 Interstate 45 North  
The Woodlands, TX 77380  
Ph: 281.367.1983